

SECTION A-A
SCALE 2 : 3

THREAD DETAIL
5 THREADS PER INCH
0.200" [5.06 PITCH]

| REFERENCE | TOLERANCE | DIMENSION | UNITS |
|-------------|---------------|----------------|---------|
| E | ±0.014 [0.35] | 4.224 [107.29] | in [mm] |
| T | ±0.014 [0.35] | 4.343 [110.31] | in [mm] |
| H | ±0.014 [0.35] | 0.558 [14.17] | in [mm] |
| OAH | ±0.014 [0.35] | 0.633 [16.08] | in [mm] |
| OD | ±0.014 [0.35] | 4.464 [113.39] | in [mm] |
| PART WEIGHT | ± 2.0 | 21.10 | g |

STATIC TORQUE RECOMMENDATION
45-70 in-lbs
THIS REQUIREMENT MAY VARY DEPENDING
UPON BOTTLE MATERIAL, NECK FINISH, AND
CAPPING EQUIPMENT

DRAWING TYPE : CUSTOMER

REPLACES DRAWINGS:
C-1019

DIMENSIONS ENCLOSED IN ()
INDICATE REFERENCE
DIMENSIONS AND NO TOLERANCE
LIMITS ARE ESTABLISHED

TOLERANCES UNLESS OTHERWISE SPECIFIED

| DIMENSION (inches) | TOLERANCE | DIMENSION (mm) | TOLERANCE |
|--------------------|-----------|----------------|-----------|
| 0-0.787 | ±0.006 | 0-20 | ±0.152 |
| 0.788-1.181 | ±0.008 | 21-30 | ±0.203 |
| 1.182-2.756 | ±0.012 | 31-70 | ±0.305 |
| 2.757-3.937 | ±0.016 | 71-100 | ±0.406 |
| 3.938-5.096 | ±0.020 | 101-150 | ±0.508 |
| 5.097-7.874 | ±0.024 | 151-200 | ±0.610 |
| 7.875-9.843 | ±0.032 | 201-250 | ±0.813 |

ANGULAR TOLERANCE ± 2°

PROPRIETARY AND CONFIDENTIAL

THIS DRAWING IS PROTECTED BY COPYRIGHT AND CONTAINS INFORMATION
PROPRIETARY TO MOLD-RITE, WEATHERCHEM AND STULL TECHNOLOGIES.
ANY REPRODUCTION, DISCLOSURE, OR USE OF ITS CONTENTS OR ANY PART
THEREOF IS EXPRESSLY PROHIBITED EXCEPT AS MOLD-RITE, WEATHERCHEM
AND STULL TECHNOLOGIES OTHERWISE MAY AGREE IN WRITING

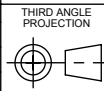

DISTRIBUTION
CODE
D

DRAWING NAME
**110-400 CT Closure
SS (Smooth Side, Smooth Top)**

DRAWING NUMBER
CQA - 10457

MATERIAL
POLYPROPYLENE

MODEL NUMBER:
PM 10455 110-400 CT

| SCALE | SHEET SIZE | SHEET | REV.NP |
|-------|------------|--------|--------|
| 1:2 | 11in*8.5in | 1 of 3 | 00.AA |

THE CLOSURE DIMENSIONS
DEPICTED ARE THOSE WHICH HAVE GENERALLY BEEN
FOUND TO BE FUNCTIONAL BASED ON INDUSTRY
EXPERIENCE BECAUSE OF VARIABILITY IN GLASS AND
PLASTIC CONTAINER FINISHES, EACH CLOSURE/FINISH
SYSTEM SHOULD BE INDIVIDUALLY EVALUATED AND
TESTED TO ENSURE IT MEETS APPLICABLE
PERFORMANCE CRITERIA. SEE QUALITY ASSURANCE
SPECIFICATIONS FOR ADDITIONAL INFORMATION.

MOLD-RITE, WEATHERCHEM AND STULL TECHNOLOGIES
RESERVES THE RIGHT TO REVISE ANY OR ALL
SPECIFICATIONS AND REQUIREMENTS.

| REVISIONS | | | | | |
|-----------|-----|-----|------------------------|-----|-----|
| DATE | REV | N/P | DESCRIPTION | ENG | DRW |
| 01/10/17 | 00 | AA | DRAWING FORMAT UPDATED | BDG | BDG |

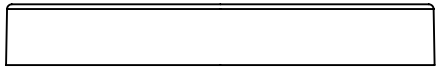
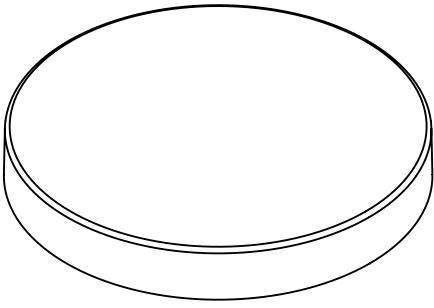
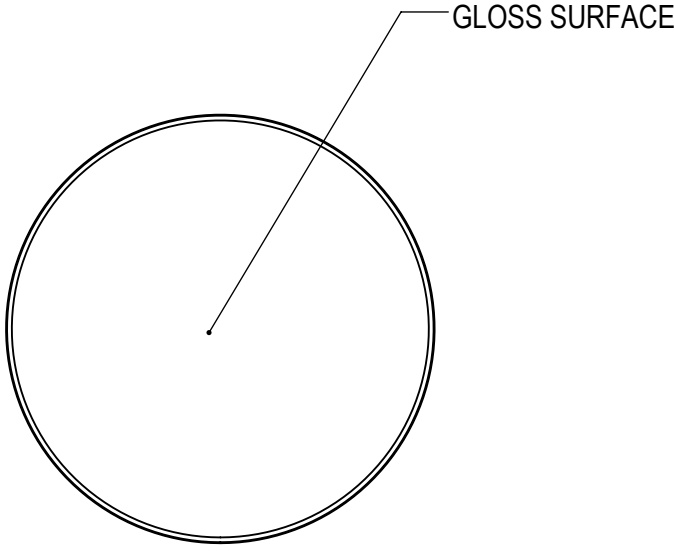

THE CLOSURE DIMENSIONS DEPICTED ARE THOSE WHICH HAVE GENERALLY BEEN FOUND TO BE FUNCTIONAL BASED ON INDUSTRY EXPERIENCE BECAUSE OF VARIABILITY IN GLASS AND PLASTIC CONTAINER FINISHES. EACH CLOSURE/FINISH SYSTEM SHOULD BE INDIVIDUALLY EVALUATED AND TESTED TO ENSURE IT MEETS APPLICABLE PERFORMANCE CRITERIA. SEE QUALITY ASSURANCE SPECIFICATIONS FOR ADDITIONAL INFORMATION.

MOLD-RITE, WEATHERCHEM AND STULL TECHNOLOGIES RESERVES THE RIGHT TO REVISE ANY OR ALL SPECIFICATIONS AND REQUIREMENTS.

| DRAWING TYPE : CUSTOMER | | | |
|---|-----------|---|-----------|
| REFERENCES: 110001, 110002 110003, 110004 | | DIMENSIONS ENCLOSED IN () INDICATE REFERENCE DIMENSIONS AND NO TOLERANCE LIMITS ARE ESTABLISHED | |
| TOLERANCES UNLESS OTHERWISE SPECIFIED | | | |
| DIMENSION (inches) | TOLERANCE | DIMENSION (mm) | TOLERANCE |
| 0-0.787 | ±0.006 | 0-20 | ±0.152 |
| 0.788-1.181 | ±0.008 | 21-30 | ±0.203 |
| 1.182-2.756 | ±0.012 | 31-70 | ±0.305 |
| 2.757-3.937 | ±0.016 | 71-100 | ±0.406 |
| 3.938-5.096 | ±0.020 | 101-150 | ±0.508 |
| 5.097-7.874 | ±0.024 | 151-200 | ±0.610 |
| 7.875-9.843 | ±0.032 | 201-250 | ±0.813 |
| ANGULAR TOLERANCE ± 2° | | | |
| PROPRIETARY AND CONFIDENTIAL | | | |
| THIS DRAWING IS PROTECTED BY COPYRIGHT AND CONTAINS INFORMATION PROPRIETARY TO MOLD-RITE, WEATHERCHEM AND STULL TECHNOLOGIES. ANY REPRODUCTION, DISCLOSURE, OR USE OF ITS CONTENTS OR ANY PART THEREOF IS EXPRESSLY PROHIBITED EXCEPT AS MOLD-RITE, WEATHERCHEM AND STULL TECHNOLOGIES OTHERWISE MAY AGREE IN WRITING | | | |



| | | | | | |
|----------------------------|-------------------------------|--|------------------------|---|-----------------|
| THIRD ANGLE PROJECTION | DISTRIBUTION CODE D | DRAWING NAME 110-400 CT Closure SS (Smooth Side, Smooth Top) | | | |
| | | DRAWING NUMBER CQA - 10457 | | | |
| DRAWN BY. BDG | 1/10/2017 | MATERIAL POLYPROPYLENE | | | |
| | | ENG APPR. BDG | 1/16/2017 | MODEL NUMBER: PM 10455 110-400 CT | |
| QA APPR. ACP | 01/18/2017 | SCALE 1:2 | SHEET SIZE 8.5 X 11 | SHEET 2 of 3 | REV.NP 00.AA |

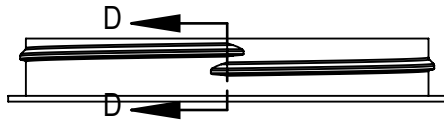
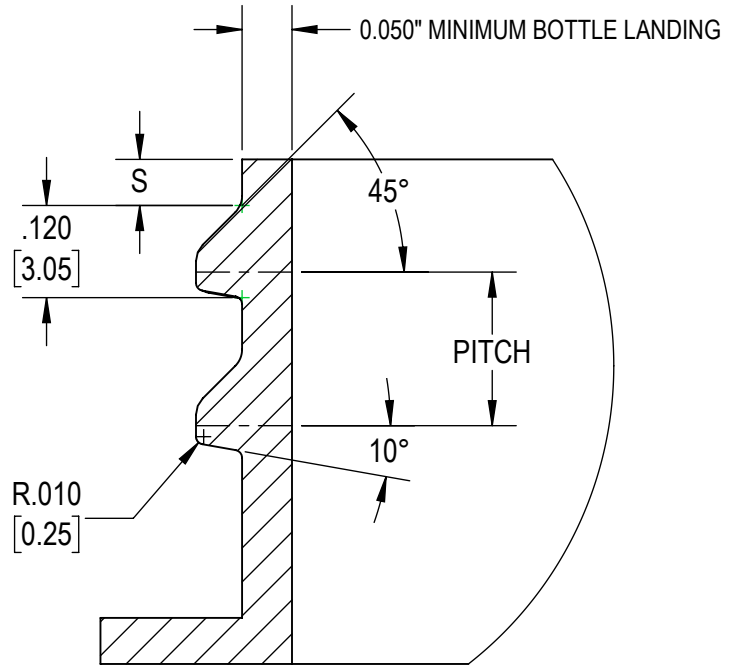
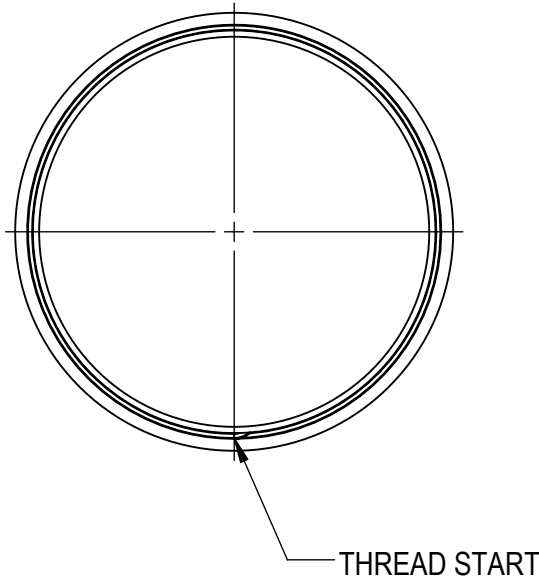

DETAIL E
SCALE 4 : 1

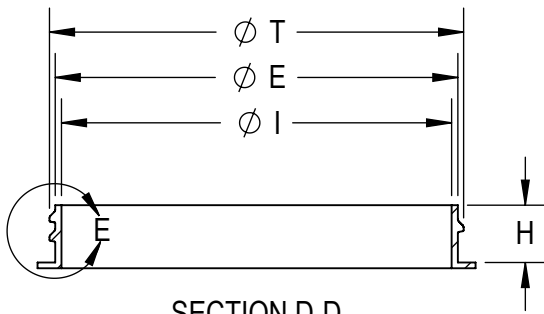

SECTION D-D

| REFERENCE | TOLERANCE | UNITS | DIMENSION |
|-----------|---------------|--------|----------------|
| E | ± 0.017[0.43] | IN[mm] | 4.194 [106.53] |
| T | ± 0.017[0.43] | IN[mm] | 4.314 [109.58] |
| I | MINIMUM | IN[mm] | 3.737 [94.92] |
| S | ± 0.015[0.38] | IN[mm] | 0.060[1.524] |
| H | MINIMUM | IN[mm] | 0.597 [15.16] |
| TPI | | | 5 |
| PITCH | | IN[mm] | 0.200 [5.04] |

DRAWING TYPE : CUSTOMER

DIMENSIONS ENCLOSED IN () INDICATE REFERENCE DIMENSIONS AND NO TOLERANCE LIMITS ARE ESTABLISHED

TOLERANCES UNLESS OTHERWISE SPECIFIED

| DIMENSION (inches) | TOLERANCE | DIMENSION (mm) | TOLERANCE |
|--------------------|-----------|----------------|-----------|
| 0-0.787 | ±0.006 | 0-20 | ±0.152 |
| 0.788-1.181 | ±0.008 | 21-30 | ±0.203 |
| 1.182-2.756 | ±0.012 | 31-70 | ±0.305 |
| 2.757-3.937 | ±0.016 | 71-100 | ±0.406 |
| 3.938-5.096 | ±0.020 | 101-150 | ±0.508 |
| 5.097-7.874 | ±0.024 | 151-200 | ±0.610 |
| 7.875-9.843 | ±0.032 | 201-250 | ±0.813 |

ANGULAR TOLERANCE ± 2°

PROPRIETARY AND CONFIDENTIAL

THIS DRAWING IS PROTECTED BY COPYRIGHT AND CONTAINS INFORMATION PROPRIETARY TO MOLD-RITE, WEATHERCHEM AND STULL TECHNOLOGIES. ANY REPRODUCTION, DISCLOSURE, OR USE OF ITS CONTENTS OR ANY PART THEREOF IS EXPRESSLY PROHIBITED EXCEPT AS MOLD-RITE, WEATHERCHEM AND STULL TECHNOLOGIES OTHERWISE MAY AGREE IN WRITING



DISTRIBUTION CODE
D

DRAWING NAME
**110-400 CT Closure
RECOMMENDED NECK FINISH**

DRAWING NUMBER
CQA - 10457

DRAWN BY: BDG 1/10/2017

ENG APPR: BDG 1/16/2017

QA APPR: ACP 01/18/2017

| | | | |
|---------------|------------------------|-----------------|------------------|
| MATERIAL | | | |
| MODEL NUMBER: | | | |
| SCALE 1:2 | SHEET SIZE 8.5 X 11 | SHEET 3 of 3 | REV/N/P 00.AA |

THE CLOSURE DIMENSIONS DEPICTED ARE THOSE WHICH HAVE GENERALLY BEEN FOUND TO BE FUNCTIONAL BASED ON INDUSTRY EXPERIENCE BECAUSE OF VARIABILITY IN GLASS AND PLASTIC CONTAINER FINISHES. EACH CLOSURE/FINISH SYSTEM SHOULD BE INDIVIDUALLY EVALUATED AND TESTED TO ENSURE IT MEETS APPLICABLE PERFORMANCE CRITERIA. SEE QUALITY ASSURANCE SPECIFICATIONS FOR ADDITIONAL INFORMATION.

MOLD-RITE, WEATHERCHEM AND STULL TECHNOLOGIES RESERVES THE RIGHT TO REVISE ANY OR ALL SPECIFICATIONS AND REQUIREMENTS.

HS 035 HEAT SEAL/20F

MRP Description - (021)HS035.020 R SFYP

- Designed as a one-piece, polystyrene backed, induction heat seal with an ethylene vinyl acetate based sealant layer that gives a tamper evident bond to Polyethylene (PE), Polypropylene (PP), Polyester (PET), Polystyrene (PS), Vinyl (PVC) and glass containers.
- Available with standard or custom print.

Typical Product Attributes

Construction

| | | | |
|---|--|------------------------------|-----------------------------|
| Polystyrene Foam Paper Aluminum Foil Heat Seal | | SI (µm) | US (Mils) |
| | | 508,0 71,1 8,9 63,5 | 20.0 2.8 0.35 2.25 |
| Minimum Width Width Tolerance | | 25,4 mm ± 1,6 mm | 1.0 inch ± 1/16 |

Properties

| | |
|---------------------------------|------------------|
| Water Vapor Transmission (WVTR) | Essentially Zero |
| Gas (O ₂) (GTR) | Essentially Zero |

Regulatory Compliance

| | |
|------------------------|---|
| FDA Compliance | 21 CFR 177.1640 Polystyrene and rubber-modified polystyrene. 21 CFR 177.1350 Ethylene-vinyl acetate copolymers. 21 CFR 177.1210 Closures with sealing gaskets for food containers 21 CFR 176.180 Components of paper and paperboard in contact with dry foods. 21 CFR 176.170 Components of paper and paperboard in contact with aqueous and fatty foods. |
| Drug Master File (DMF) | 2518 |
| Other Compliances | USFDA Food Allergen Guidelines; California Proposition 65 Labeling Requirements; Limitations of Heavy Metals in Packaging per CONEG & EU 94/62/EC, Article 11 |

Original Date: 2016-03-25
Revised Date: N/A
Revision Number: 0
Created by PEY

DISCLAIMER: This information is believed to be accurate at the time of printing and is subject to change without notice. Providing this information does not convey any licenses under any patent rights or intellectual property rights of Tri-Seal or others. TRI-SEAL MAKES NO WARRANTY, EXPRESS OR IMPLIED, WITH RESPECT TO THIS INFORMATION AND DISCLAIMS ALL LIABILITY FROM RELIANCE ON IT. Tri-Seal's only warranties for this product are those written warranties as may be agreed to by Tri-Seal and its customers. TRI-SEAL SPECIFICALLY DISCLAIMS ALL OTHER WARRANTIES, EXPRESS OR IMPLIED, WITH RESPECT TO THE PRODUCT, INCLUDING, BUT NOT LIMITED TO, WARRANTIES OF MERCHANTABILITY AND FITNESS FOR PARTICULAR PURPOSE.

Tri-Seal
a Tekni-Plex company
16125 Armour St. N.E.
Alliance, OH 44601
Tel: 330-821-1166 – Fax: 330-821-0364
www.tri-seal.tekni-plex.com