

REV	ECN	DESCRIPTION	BY	DATE
F	-	ADD STACK PACK TO HEAVY GRAM	SJ	09-OCT-01
G	-	DOC CHANGE ONLY, PROD CONFORMS	SCT	19-NOV-01
H	-	ADDED METRIC DIMENSIONS	SCT	12-MAY-10
I	-	N/A		
J	-	ADD ALT CONFIG	SCT	4-NOV-10
K	-	28g CHANGED TO 33.5g	RAB	06-FEB-13
L	-	WT TOL (±1)	SCT	13-NOV-13
M	-	REMOVE 33.5g WT	RAB	23-SEP-15
N	-	ADDED NECK FINISH NOTE, TOLERANCE NOTE & UPDATED DWG.	JAZ	06-MAY-19

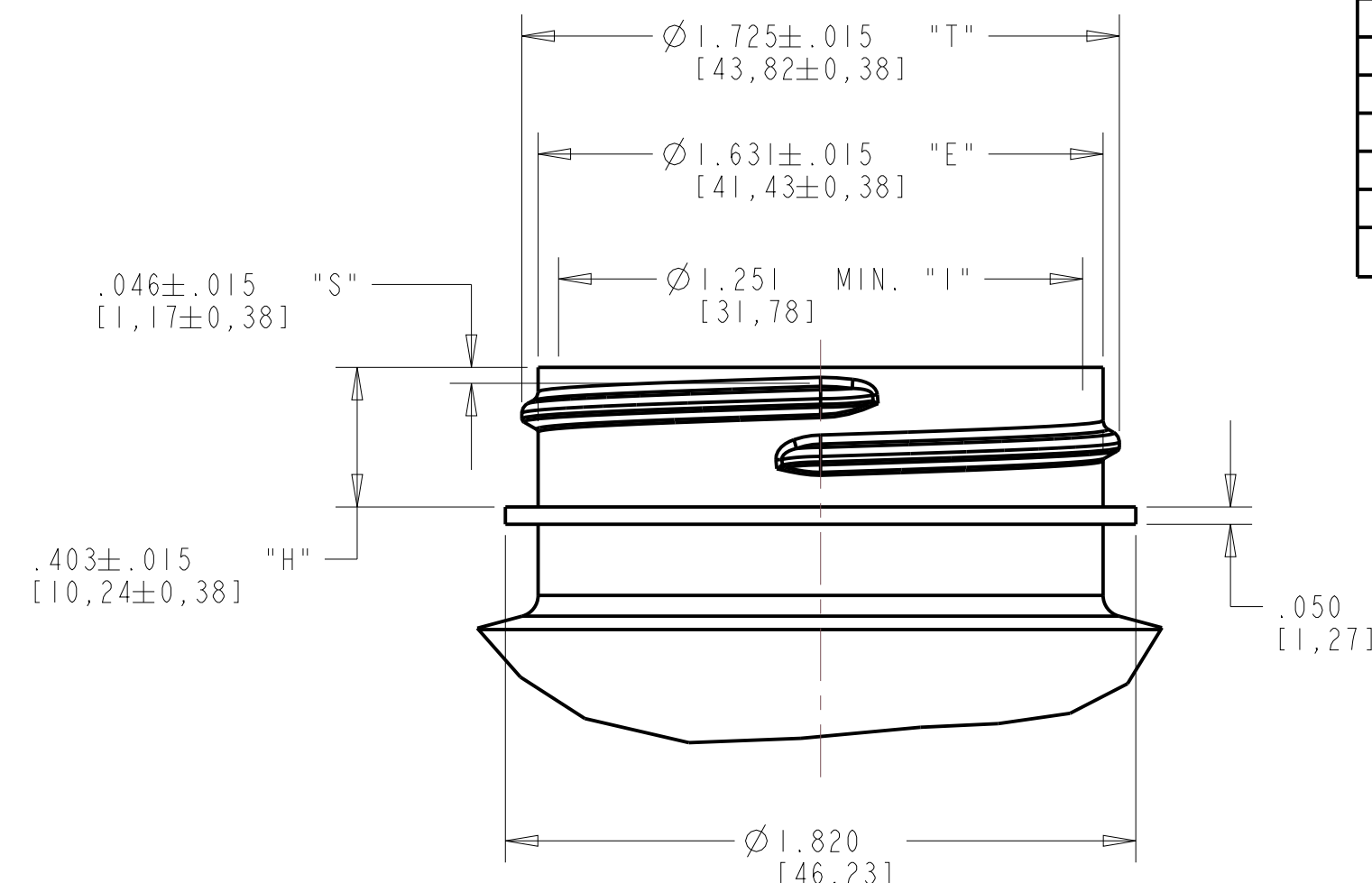

NECK DETAIL
SCALE: 2:1

FINISH SPECIFICATIONS:
 1. FINISH: L45-400
 2. NO. OF TURNS: 1 FULL TURN
 3. THREADS PER INCH: 6
 4. THREAD START: 90° FROM P.L. (AS SHOWN)

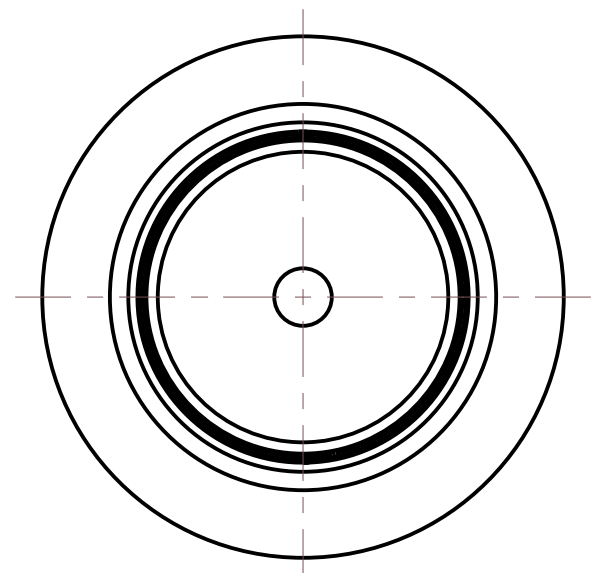
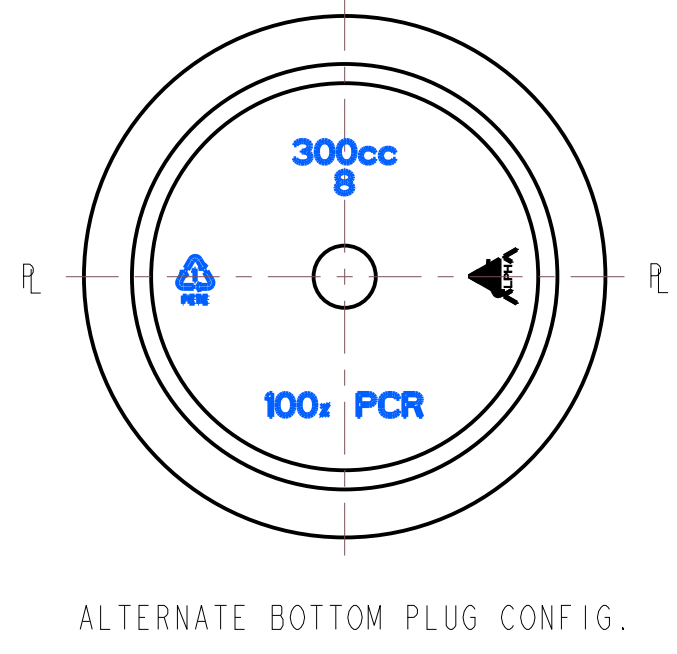
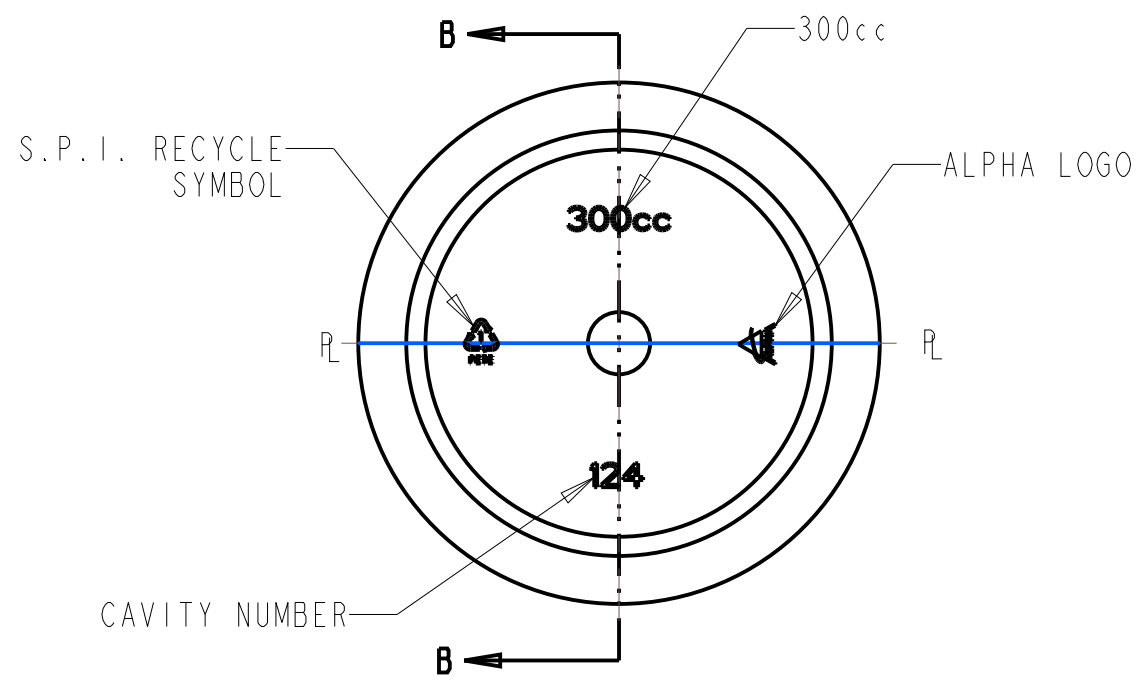
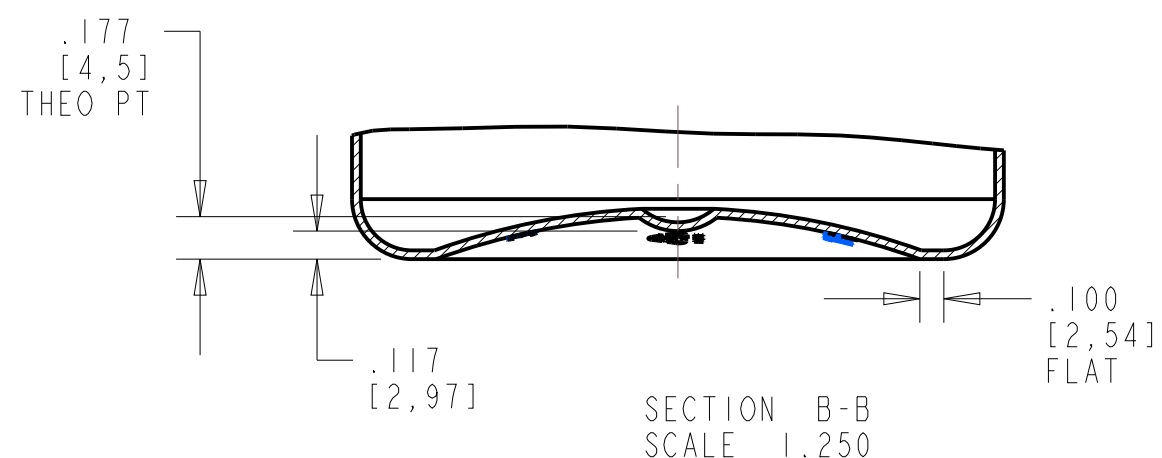
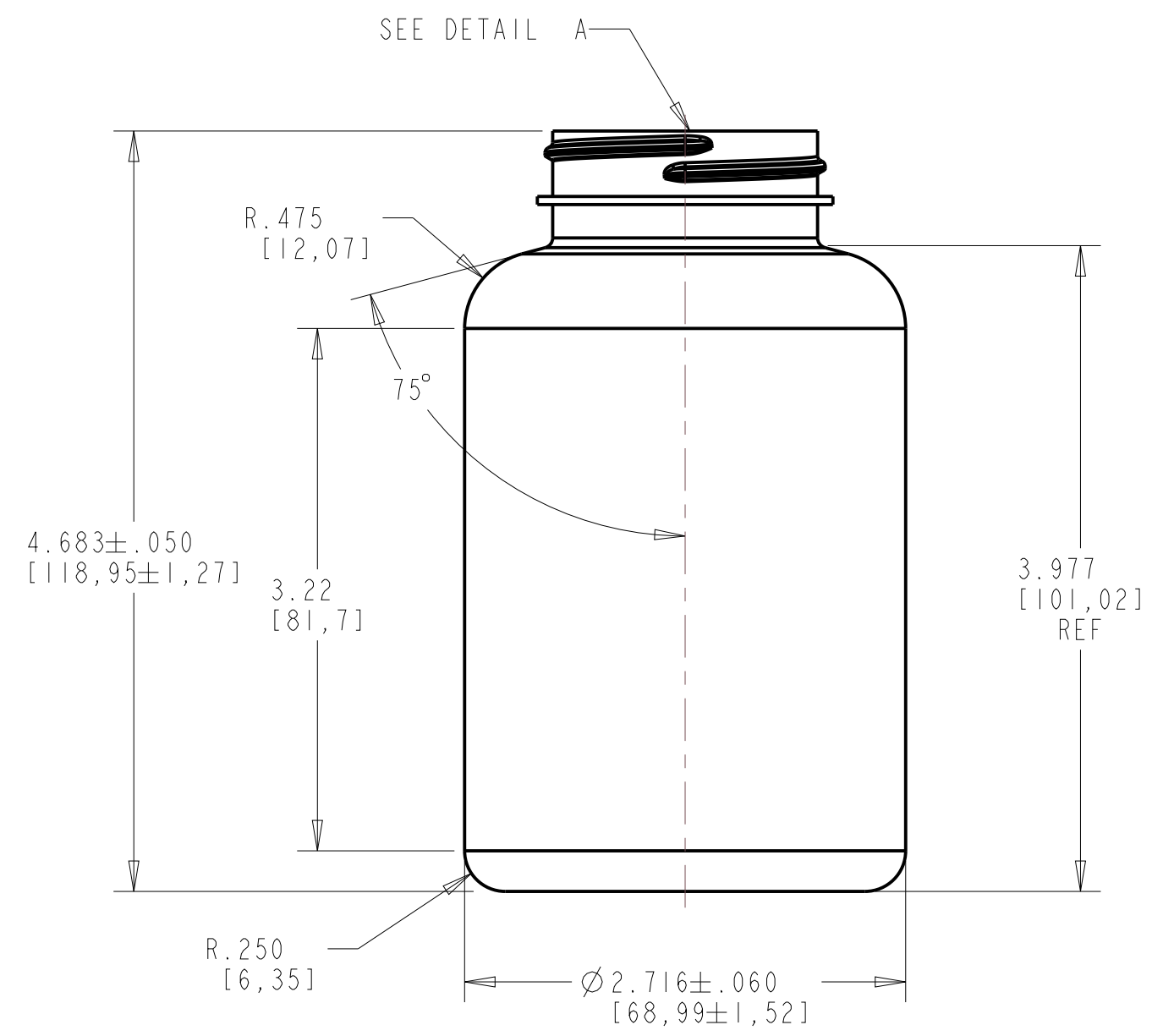

NOTES:
 1. CRITICAL DIMENSIONS ARE SHOWN WITH TOLERANCES. CRITICAL DIMENSION TO BE USED FOR QC PURPOSES.
 2. ALL OTHER DIMENSIONS TO BE USED FOR REFERENCE ONLY.

Alpha Packaging, Inc.		DISCLAIMER: Alpha Packaging assumes no responsibility for form, fit and function of closures, accessories, and/or shelf life and compatibility of intended contents with this bottle.	
Specification General:	Min. Thk (in.)	Weight (g)	Overflow (mL)
All measurements are in inches, [mm]	.012 [0,3]	37.0 ±3.0	368.0 ±9.0
Base engraving is subject to change location & size			
Tolerance where not shown	NECK FINISH:	L45-400	300cc STRAIGHT SIDED
Decimal ±0.05 [1,27]	MATERIAL:	PET	Approved By: SJ
Angular ±1°			Drawing Number: 300PS1XX45L400